

NOTE TO TRUSS MANUFACTURE:

2019.11.27 – Manufactured Items and Materials

All materials like a truss, floor joist, beams, etc. **CAN NOT** be designed, put into production or purchased for installation based upon these drawings alone.

MUST

ALL dimensions need to be verified during construction and before the material is purchased, ordered or put into production. The manufacture, like the truss manufacturer, builder, contract or framer

review all relevant dimensions and inform Virtual Creations and the manufacture of any discrepancies. At the minimum the client must at least contact Virtual Creation to review the as build condition before purchasing, ordering or putting into production any and all materials.

FAILURE to verify these dimensions will absolve Virtual Creations of any responsibility of errors or discrepancies in our plans. By paying this invoice you agree to this requirement and condition.

DIMENSION NOTE:

2019.12.05 – There are different ways of dimension architectural floors, what follows is an explanation of the why interior walls are dimensioned as 4" or 6" vs other methods.

Some Architectural drawings chose to dimension the rough wood stud framing. However this would create a lot fractioned dimensions on the plans and would require the framer to account for the 1/2" drywall material in some conditions like bathroom tubs and stair wells.

Some Architectural drawings chose to dimension the finished wall thickness. However this would create a lot fractioned dimensions as well.

These Architectural set of drawings chose to dimension interior walls to a round 4" or 6" dimension. We feel this is the cleanest dimension as they do not have fractions, and at most produce a 1/4" error which isn't typically an issue. Further we full appreciate that we can not ask trades in the field to measure to 1/4" accuracies nor to we assume that as built construction could hold those tolerances.

9.9.10.1 Egress from Bedrooms

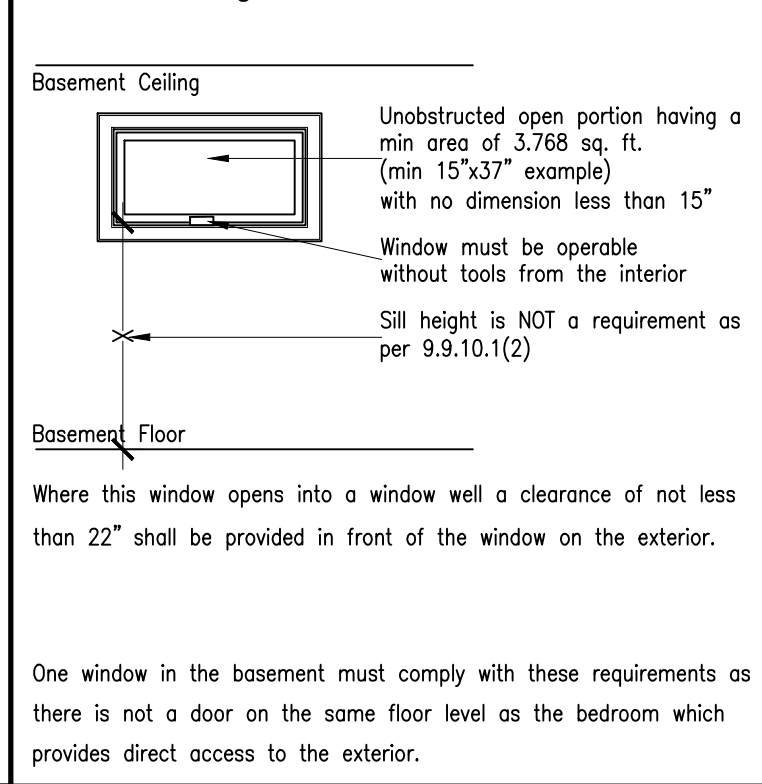

Part 4 Loads used

- 20lb Dead Load
 - 40lb Live Load (interior)
 - 50lb Live Load (exterior)
 - 32lb Snow Load
 - 10lb Wind Load
- Deflection limits**
- L/425 Floors (interior)
 - L/360 Floors (exterior)

Commitment to General Review

| | |
|--------------------------|--------------------------|
| Yes | No |
| <input type="checkbox"/> | <input type="checkbox"/> |

OBC 9.10.19.3 – Smoke Alarms
(Renovations Only)

Existing smoke alarms are acceptable, however, if the scope of work involves renovating existing bedrooms, changing room uses from a non bedroom use to proposed bedroom use or an addition which includes a bedroom many requirements of 9.10.19.3 would apply including being interconnected, hardwired and with visual notification. If a smoke alarm is required it will be noted on drawings

Notes: Engineering Drawings

These drawings shall be read in association with the engineering floor joist and specifications as well as the engineering truss layout and specification.

Electrical Safety Authority

Doing electrical work? A notification must be filed with the Electrical Safety Authority. Hiring someone to do electrical contractor.

It's the law.

For more information go to www.esosafe.com or call 1-877-372-7233

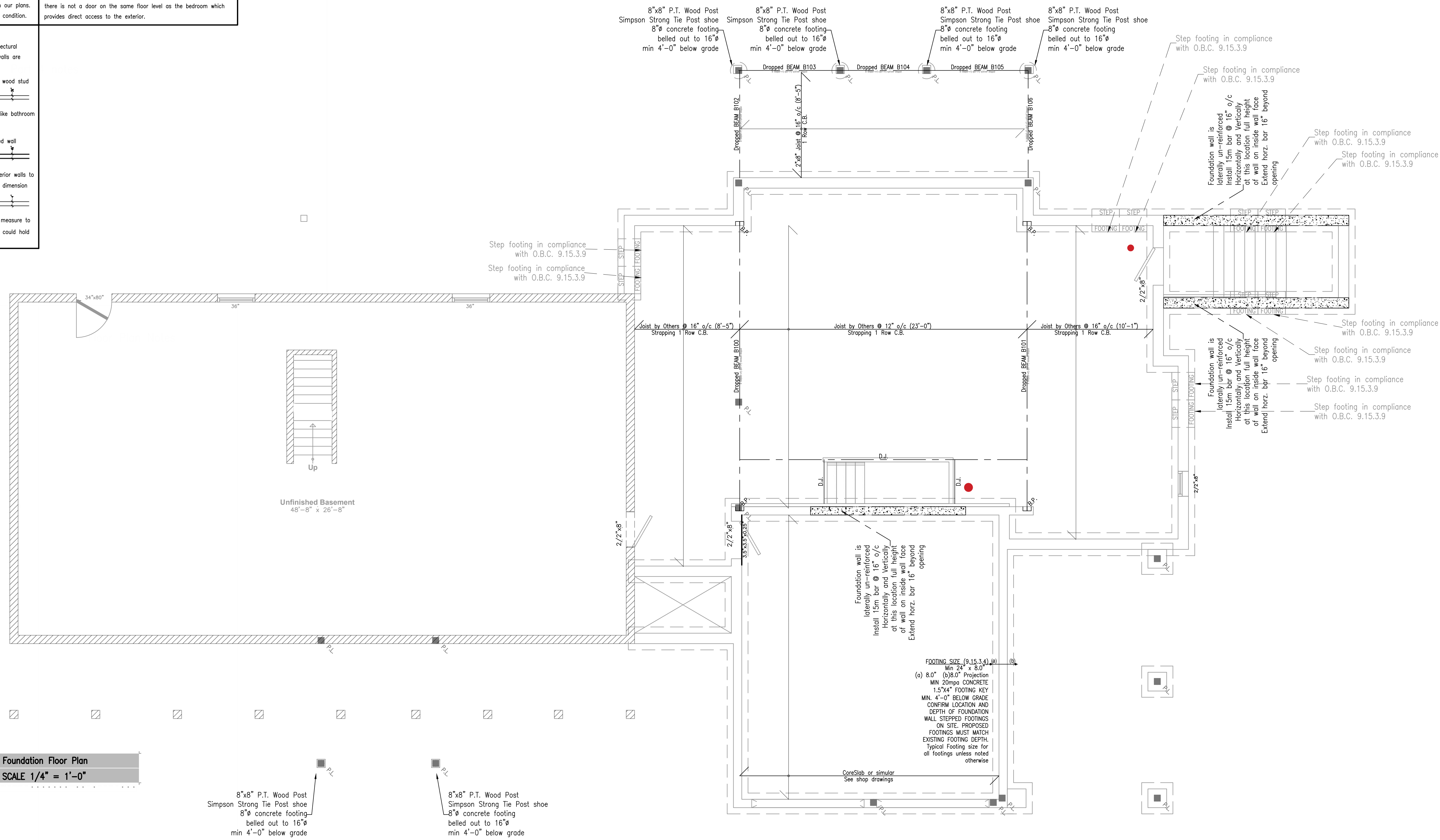

A Foundation Floor Plan
VO1 SCALE 1/4" = 1'-0"

8"x8" P.T. Wood Post
Simpson Strong Tie Post shoe
8"Ø concrete footing
belled out to 16"Ø
min 4'-0" below grade

Foundation Floor Plan
SCALE 1/4" = 1'-0"

VIRTUAL CREATIONS INC. PROJECT No:2021-695
(905) 481 1153 BCIN No. 28844
ERIC CANTON BCIN#25135

PROJECT:542 Woodhill Road, Troy Ontario
Client: Connie Stepiens
Classification: Original Signature:

SMALL BUILDINGS
WWW.VCINC.CA

AT VIRTUAL CREATIONS INC. THE BEST EFFORT HAS BEEN MADE TO RECORD EXISTING BUILDING STRUCTURES AND PROPOSED A COMPREHENSIVE SET OF CONSTRUCTION DRAWINGS. HOWEVER, THERE ARE AREAS AT THE TIME OF DESIGNING THAT ARE UNAVAILABLE OR INACCESSIBLE. WITH PROPER CO-ORDINATION ELEMENTS SUCH AS ROOF TRUSSES AND ENGINEERED FLOOR JOIST TO VIRTUAL CREATIONS INC. TO REVIEW PRIOR TO FABRICATION. DETERMINE LOCATIONS OF EXISTING SERVICES. INFORM VIRTUAL CREATIONS INC. OF ANY CHANGES, DISCREPANCIES OR SUBSTITUTIONS FOR REVIEW BEFORE COMMENCING CONSTRUCTION. ALL DESIGNS AND DRAWINGS ARE THE SOLE PROPERTY AND COPYRIGHT OF VIRTUAL CREATIONS INC. ANY REPRODUCTIONS MUST BE AUTHORIZED BY VIRTUAL CREATIONS INC OR PURCHASED THROUGH VIRTUAL CREATIONS INC DIRECTLY.

ISSUED Dec 10 2021